

MARQ™

GESTURE SPOT 300

Quickstart Guide

English

Introduction

Box Contents

Gesture Spot 300

Quickstart Guide

Power Cable

Safety & Warranty Manual

DMX Cable

Important: Visit marqlighting.com to download the complete *User Guide*.

Support

For the latest information about this product (documentation, technical specifications, system requirements, compatibility information, etc.) and product registration, visit marqlighting.com.

For additional product support, visit marqlighting.com/support.

Safety Notes

Important: In addition to the notes below, please refer to the included safety & warranty manual for additional safety information.

- Carry this product by the hanging/mounting bracket or the handles only.
- Use this product **indoors only** (IP20). To prevent risk of fire or shock, do not expose this product to rain or moisture.
- Do **not** use this product for permanent installations.
- Connect this product to grounded and protected circuits only.
- Always disconnect it from its power source **before** cleaning or replacing this product's fuse. Replace the fuse with another of the same type and rating.
- Before connecting the product to a power source, make sure the power cable is not crimped or damaged.
- Make sure the power outlet's voltage is within the range stated on this product (on its housing or decal).
- **Never** connect this product to a dimmer or rheostat.
- **Never** disconnect this product from the power cable by pulling or tugging on the cable itself.
- If you mount this product overhead, use a safety cable.
- Always make sure this product is used in a location with adequate ventilation with at least 20" (50cm) from adjacent surfaces. Make sure none of this product's ventilation slots are obstructed.
- Do **not** use this product at ambient temperatures higher than 104 °F / 40 °C.
- Do **not** allow flammable materials near this product during use.
- Do **not** look at the light source when the product is on.
- Do **not** touch this product while it is powered on or immediately after powering it off. The product and its housing can reach high temperatures.
- If you encounter a serious problem while using this product, stop using it **immediately**.
- Do **not** open this product's housing. It contains no user-serviceable parts and will void your warranty.

Features

Rear Panel

- Power In:** Use a standard power cable (included) to connect this input to a power outlet.
- Fuse:** This compartment holds the fuse. **Before** cleaning or replacing the fuse, **disconnect Gesture Spot 300 from its power source.** Use a screwdriver or other tool to remove the compartment (do **not** pull it out by the tab only). Replace the fuse only with a new fuse with the same rating (**250 V, 4 A**).
- DMX In:** Use a standard 3-pin DMX cable to connect this input (**A**) to your DMX controller or (**B**) to another fixture that will pass DMX data through it to this one. Gesture Spot 300 receives DMX data over this connection. Please see [Setup > Linking > DMX](#) for information about linking multiple fixtures.
- DMX Out:** Use a standard 3-pin DMX cable to connect this output to an additional fixture. Gesture Spot 300 sends its data to an additional fixture over this connection. Please see [Setup > Linking > DMX](#) for information about linking multiple fixtures.

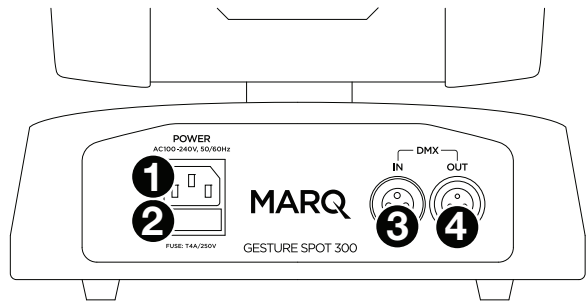

Front Panel

- Display:** This display shows messages and values indicating the fixture's current status.
- Menu:** Press this button to access Gesture Spot 300's menu.
- Up:** Press this button to select the next-highest menu option or to increase the value by 1.
- Down:** Press this button to select the next-lowest menu option or to decrease the value by 1.
- Enter:** Press this to confirm your current selection or value.
- DMX:** This light will illuminate when Gesture Spot 300 is receiving DMX data properly through its **DMX In**.
- Error:** This light will illuminate when Gesture Spot 300 receives an invalid DMX command.

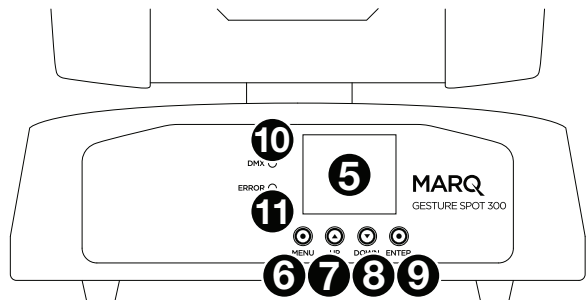

Setup

Note: Items not listed under the [Introduction > Box Contents](#) are sold separately.

Power Information

Before connecting the fixture to a power outlet, make sure the power cable is not crimped or damaged. Also, make sure the power outlet's voltage is within the range stated on this product (on its housing or decal).

Before cleaning or replacing the fuse, **disconnect Gesture Spot 300 from its power source**. Use a screwdriver or other tool to remove the compartment (do **not** pull it out by the tab only). Replace the fuse only with a new fuse with the same rating (**250 V, 4 A**).

Mounting/Rigging

Standing

Place the fixture on a flat, stable surface. Make sure all cables are secured and placed so that no one will trip over them.

Suspended

Follow these steps to use the hanging bracket (included) for mounting the fixture to a truss.

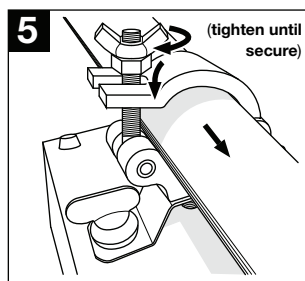
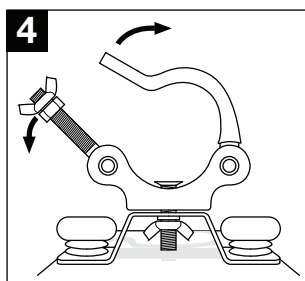
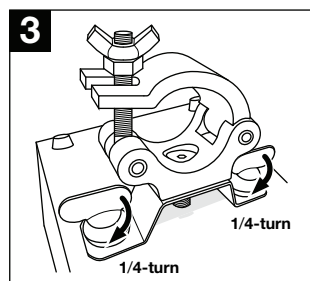
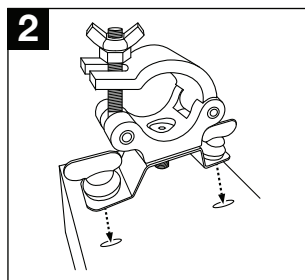
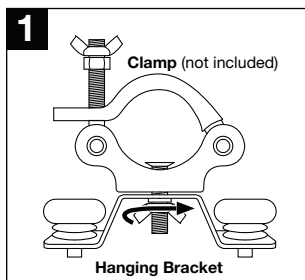

Linking

When using multiple Gesture Spot 300 fixtures, you can link (“daisy-chain”) them so that each each fixture sends **DMX data** to the next one. This helps reduce clutter in your cabling and save you setup time.

DMX

Use a standard 3-pin DMX cable to connect the **DMX Out** of one fixture to the **DMX In** of another. Your connected DMX controller will send its data to the fixtures in sequence. All fixtures in this chain will receive all DMX data.

According to the DMX standard, you can link up to 32 fixtures with up to 300 feet (91 meters) between each fixture, without amplification. Keep in mind the number of channels you are using as well as the starting address.

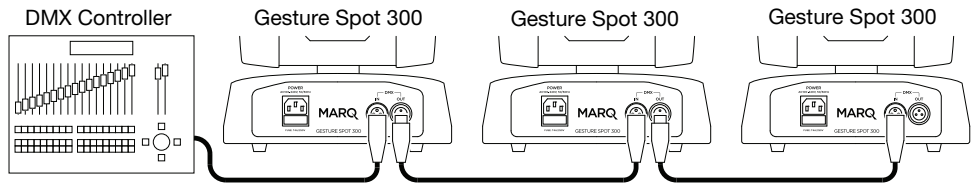

Operation

Menu Options

Menu	Submenu	Settings/Values	Description
DMX Function	DMX Address	001–512	DMX address setting
	Channel Mode	13Ch	13-channel operation
		7Ch	8-channel operation
	No DMX Signal	Keep	When no DMX signal, do nothing (hold)
		Auto	When no DMX signal, enter Run Mode
		Clear	When no DMX signal, black out
	DMX Monitor		View values received on DMX channels
Auto Movement	Run Mode	See Description	DMX, Sound, Random, 8 auto movement programs
	Sound Active	On, Off	Sound activation
	Sound Sense	000–100	Sound-activation microphone sensitivity, low (000) to high (255)
	Slave Mode	Slav 1–4	4 slave modes
Manual Test	Pan	000–255	Pan angle, 0° (000) to 540° (255)
	Pan Fine	000–255	Fine control of panning
	Tilt	000–255	Tilt angle, 0° (000) to 270° (255)
	Tilt Fine	000–255	Fine control of tilting
	Pan/Tilt Time	000–255	Pan/tilt speed, fast (000) to slow (255)
	Dimmer	000–255	Dimmer, dark (000) to bright (255)
	Stop/Strobe	000–255	Shutter (see 13-Channel Operation > Channel 7)
	Color	000–255	Color options (see 13-Channel Operation > Channel 8)
	Gobo Change	000–255	Gobo options (see 13-Channel Operation > Channel 9)
	Gobo Rotation	000–255	Rotation, slow (000) to fast (255)
	Prism Insertion	000–255	3-facet prism
	Macro Function	000–255	Macro functions (see 13-Channel Operation > Channel 12)
	Ctrl Functions	000–255	Blackout & reset functions (see 13-Channel Operation > Channel 13)
Fixture Settings	Pan Limit	540°, 360°, 180°	Select range of pan angle: 540°, 360°, or 180°
	Tilt Limit	270°, 180°, 90°	Select range of tilt angle: 270°, 180°, or 90°
	Invert Pan	On, Off	Invert pan direction
	Invert Tilt	On, Off	Invert tilt direction
	Swap Pan-Tilt	On, Off	Switch pan and tilt
	Pan-Tilt Correction	On, Off	Correct pan and tilt
	Load Default All	OK, Cancel	Restore default pan and tilt settings

Menu Options (continued)

Display Settings	Inverse	▶	Invert control panel's display
	Auto-Off	On, Off	Automatically turn off display when not in use
Fixture Information	Firmware		Currently installed firmware version
	Total Use Hours		Total running time (HHHHH:MM)
	Current Use Hours		Current use running time (HHHHH:MM)
Offset Calibration	Pan Calibration	-128 – +127	Offset for pan value
	Tilt Calibration	-128 – +127	Offset for tilt value
	Color Calibration	-128 – +127	Offset for color value
	Gobo Calibration	-128 – +127	Offset for gobo value
	Gobo Rot. Calibration	-128 – +127	Offset for gobo rotation value
	Prism Insertion	-128 – +127	Offset for prism value
Reset All		OK, Cancel	Restore all default settings

DMX Functions

You can control Gesture Spot 300 by linking it to a DMX controller. Please see the complete *User Guide* at marqlighting.com to learn how to do this. See below for charts of available functions.

13-Channel Operation

Channel	Function	Value	Description
1	Pan	000–255	Pan angle, 0° (000) to 540° (255)
2	Pan Fine	000–255	Fine control of panning
3	Tilt	000–255	Tilt angle, 0° (000) to 270° (255)
4	Tilt Fine	000–255	Fine control of tilting
5	Pan/Tilt Speed	000–255	Pan/tilt speed, fast (000) to slow (255)
6	Dimmer	000–255	Dimmer, dark (000) to bright (255)
7	Shutter	000–003	Closed
		004–007	Open
		008–076	Strobe, slow (008) to fast (076)
		077–145	Pulse, slow (077) to fast (145)
		146–215	Random strobe, slow (146) to fast (215)
		216–255	Open

13-Channel Operation (continued)

Channel	Function	Value	Description
8	Color Wheel	000-006	White
		007-013	Red
		014-020	Green
		021-027	Blue
		028-034	Yellow
		035-041	Purple
		042-048	Light Blue
		049-055	Orange
		056-063	Pink
		064-127	Color indexing
		128-189	Clockwise, fast (128) to slow (189)
		190-193	Stop
		194-255	Counterclockwise, slow (194) to fast (255)
9	Gobo Wheel See Technical Specifications > Gobos to view gobo patterns.	000-007	Open/white
		008-015	Gobo 1
		016-023	Gobo 2
		024-031	Gobo 3
		032-039	Gobo 4
		040-047	Gobo 5
		048-055	Gobo 6
		056-063	Gobo 7
		064-071	Open spot shaking, slow (064) to fast (071)
		072-079	Gobo 1 shaking, slow (072) to fast (079)
		080-087	Gobo 2 shaking, slow (080) to fast (087)
		088-095	Gobo 3 shaking, slow (088) to fast (095)
		096-103	Gobo 4 shaking, slow (096) to fast (103)
		104-111	Gobo 5 shaking, slow (104) to fast (111)
		112-119	Gobo 6 shaking, slow (112) to fast (119)
		120-127	Gobo 7 shaking, slow (120) to fast (127)
		128-189	Counterclockwise gobo change, fast (128) to slow (189)
		190-193	Stop at current position
		194-255	Clockwise gobo change, slow (194) to fast (255)
		10	Gobo Rotation
128-189	Counterclockwise gobo scroll, fast (128) to slow (189)		
190-193	Stop at current position		
194-255	Clockwise gobo scroll, slow (194) to fast (255)		
11	Prism	000-127	No function
		128-255	Prism effect

13-Channel Operation (continued)

Channel	Function	Value	Description
12	Macro Functions	000–007	No function
		008–023	Automatic movement 1
		024–039	Automatic movement 2
		040–055	Automatic movement 3
		056–071	Automatic movement 4
		072–087	Automatic movement 5
		088–103	Automatic movement 6
		104–119	Automatic movement 7
		120–135	Automatic movement 8
		136–151	Sound-active movement 1
		152–167	Sound-active movement 2
		168–183	Sound-active movement 3
		184–199	Sound-active movement 4
		200–215	Sound-active movement 5
		216–231	Sound-active movement 6
		232–247	Sound-active movement 7
248–255	Sound-active movement 8		
13	Control Functions	000–049	No function
	All functions are executed after 2 seconds.	050–059	Blackout during pan/tilt or colo/gobo change
		060–069	Disable blackout during pan/tilt or colo/gobo change
		070–079	Blackout during pan/tilt
		080–089	Disable blackout during pan/tilt
		090–099	Blackout during color change
		100–109	Disable blackout during color change
		110–119	Blackout during gobo change
		120–129	Disable blackout during gobo change
		130–139	No function
		140–149	Reset pan/tilt
		150–169	Reset color/gobo/focus/prism
		170–199	No function
		200–209	Reset all
		210–255	No function

7-Channel Operation

Channel	Function	Value	Description
1	Pan	000–255	Pan angle, 0° (000) to 540° (255)
2	Tilt	000–255	Tilt angle, 0° (000) to 270° (255)
3	Shutter	000–003	Closed
		004–007	Open
		008–076	Strobe, slow (008) to fast (076)
		077–145	Pulse, slow (077) to fast (145)
		146–215	Random strobe, slow (146) to fast (215)
		216–255	Open
4	Color Wheel	000–006	White
		007–013	Red
		014–020	Green
		021–027	Blue
		028–034	Yellow
		035–041	Purple
		042–048	Light Blue
		049–055	Orange
		056–063	Pink
		064–127	Color indexing
		128–189	Clockwise, fast (128) to slow (189)
		190–193	Stop
		194–255	Counterclockwise , slow (194) to fast (255)
5	Gobo Wheel See Technical Specifications > Gobos to view gobo patterns.	000–007	Open/white
		008–015	Gobo 1
		016–023	Gobo 2
		024–031	Gobo 3
		032–039	Gobo 4
		040–047	Gobo 5
		048–055	Gobo 6
		056- 063	Gobo 7
		064–071	Open spot shaking, slow (064) to fast (071)
		072–079	Gobo 1 shaking, slow (072) to fast (079)
		080–087	Gobo 2 shaking, slow (080) to fast (087)
		088–095	Gobo 3 shaking, slow (088) to fast (095)
		096–103	Gobo 4 shaking, slow (096) to fast (103)
		104–111	Gobo 5 shaking, slow (104) to fast (111)
		112–119	Gobo 6 shaking, slow (112) to fast (119)
		120–127	Gobo 7 shaking, slow (120) to fast (127)
		128–189	Counterclockwise gobo change, fast (128) to slow (189)
		190–193	Stop at current position
		194–255	Clockwise gobo change, slow (194) to fast (255)
		6	Gobo Rotation
128–189	Counterclockwise gobo scroll, fast (128) to slow (189)		
190–193	Stop at current position		
194–255	Clockwise gobo scroll, slow (194) to fast (255)		
7	Prism		
128–255		Prism effect	

Technical Specifications

Specifications are subject to change without notice.

Light	Type	LED
	Power	60 W
	Colors	8 + white, split colors, scrolling
	Gobos	7 + open, slot-and-lock replaceable with rotation, indexing, gobo shake & scrolling 0.93" (23.5 mm) outside 0.75" (19 mm) image 0.04" (1.1 mm) max thickness
	Illuminance	3,700 lux @ 3 m (9.8 ft.)
	Beam Angle	18°
	Strobe Rate	0–20 Hz + pulse and random
	Pan Ranges	540°, 360°, 180°
	Tilt Ranges	270°, 180°, 90°
	Focus	Manual
	Prism	3-facet with rotation and indexing
	DMX	Display
Connections		1 3-pin input for DMX 1 3-pin output for DMX
Channel Profiles		7, 13
Power	Supply	Switching (internal) Automatic voltage selection
	Connection	Standard IEC input
	Consumption	84 W, 36 V, 2 A at 230 V, 50 Hz
	Input Voltage	110–240 VAC, 50/60 Hz
	Fuse	250 V, 4 A
Physical / Mechanical	Mounting	1/4-turn hanging bracket (clamp not included)
	Dimensions (width x depth x height)	23.8" x 12.6" x 11.0" 605 x 320 x 279 mm
	Weight	12.4 lbs. 5.6 kg

Lumen Output

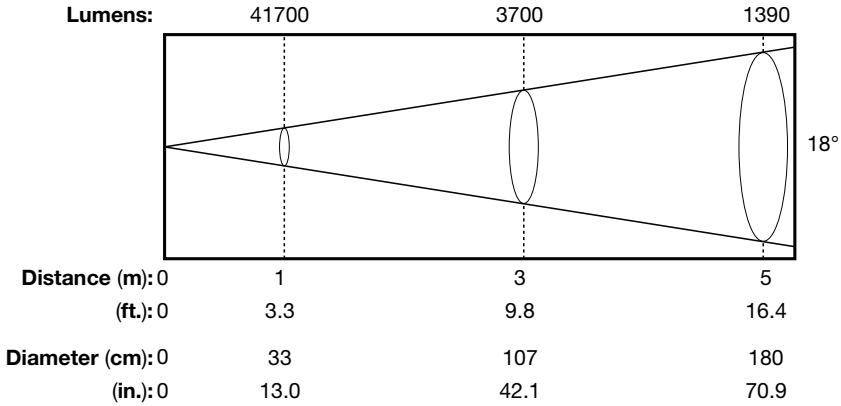

Gobos

These are the 7 gobos included with Gesture Spot 300.

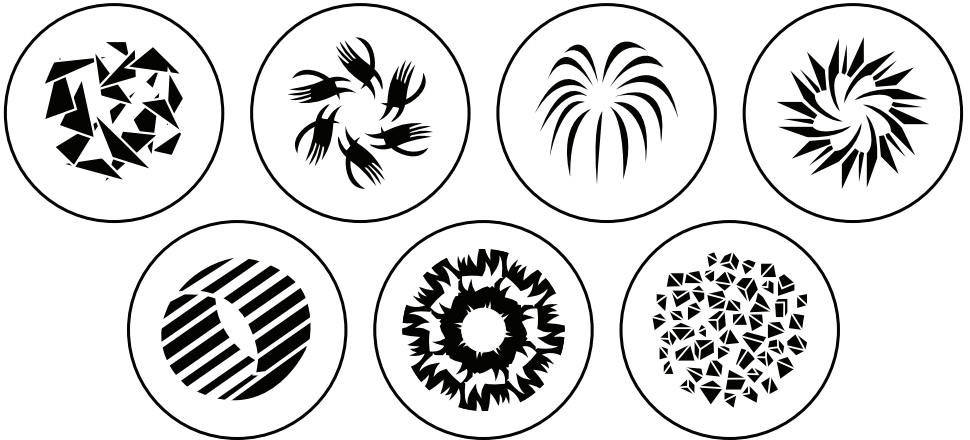

marqlighting.com

Manual Version 1.2